

JONGERT®



SY IMPRESSION

YN387

Jongert B.V. Kluisgat 1 1771 MV Wieringerwerf The Netherlands +31 (0) 227 549 400 info@jongert.nl www.jongert.nl

Bank account: ING Bank 75 17 461 Swiftcode: INGBNL2A IBAN: NL41 INGB 0007517461 K.v.K. Hoorn nr.: 53202422 BTW: NL850791844B01

Op al onze leveringen en diensten zijn de leveringsvoorwaarden van de HISWA van toepassing, gedeponeed ter Griffie van de Arrondissementsrechtbank te Amsterdam op 22 oktober onder nummer 203/1998.



JONGERT®

In this document a basic yard delivery has been described as well as a summary of basic technical data which is a part of the Jongert 26T - SY IMPRESSION.

Model	Jongert 26T
Year	1995
Accommodation	6 guests in 3 cabins + 2/4 crew
Dimensions	Length over all 31,30 m (incl. hydraulic platform)
	Length hull 26,00 m. (85'4")
	Length waterline 20,40 m. (66'11")
	Beam 6,70 m. (22' 0")
	Draught 3,95 m.
Engine	1x MTU 299 Hp with Hundersted variable pitch prop
Sales price	€ 1.650.000,-
VAT Status	Not paid
Registry	Jersey, British Displacement 110 t.
Lying	Spain or The Netherlands
Description	Ketch rigged yacht with closed wheelhouse
Method of construction	Round bilge
Hull material	Steel
Keel	Sheel-type Keel
Type	Ketch
Shipyard	Jongert BV, The Netherlands
Naval architect	Jongert design team & Doug Peterson
Interior designer	Peter Sijm Draft
Fuel tank capacity	6.000 ltr
Fresh Water tank capacity	4.200 ltr

IMPRESSION is a classic ketch sailing yacht with sparkling sailing performance for fast ocean passages and long periods on board. Her perfectly crafted joinery and general air of quality satisfy the most stringent demands. The main saloon is connected to the deck saloon by an open gallery. The flood of natural light admitted through the full with windows creating a friendly atmosphere and giving an impression of wide and comfortable space.

Owners cabin. In the luxurious owners suite there is a large double bed, a sofa, desk and a spacious bathroom with separate shower. The traditional large transom windows create an uniquely Jongert atmosphere and together with the portlights in the hull a 270 degrees view. Also the guest cabins are spacious each with large twin beds. Each cabin features its own bathroom with separate shower. Air-conditioning is individually adjustable per cabin. Privacy is ensured by a private passageway from the deckhouse separating the owners and guest accommodation from the crew area in the fore part of the yacht.

Disclaimer

All specifications and details given are provided for general information only. Jongert offers the details of this vessel in good faith but cannot guarantee or warrant the accuracy of this information nor warrant the condition of the vessel. We therefore recommend clients to have yachts, specifications and information thoroughly checked and surveyed for accuracy by an independent qualified marine surveyor and purchase only subject to satisfactory survey and sea trial. This vessel is offered subject to prior sale, price change, or withdrawal without prior notice. The dimensions, capacities, speeds etc. are approximate. All information given is subject to fair, wear and tear.

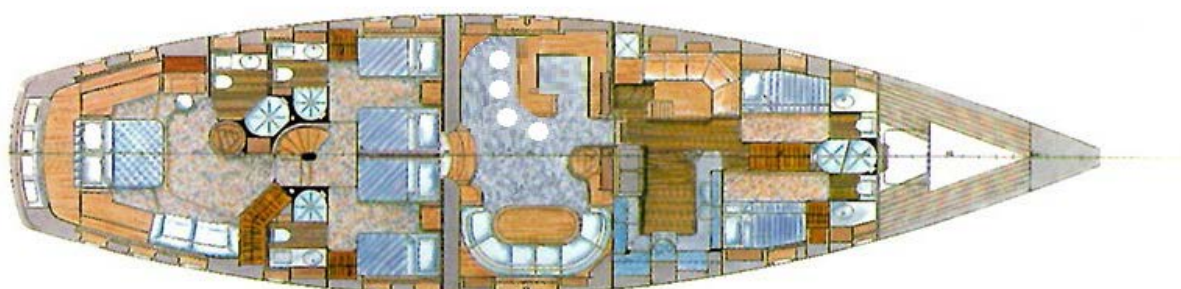
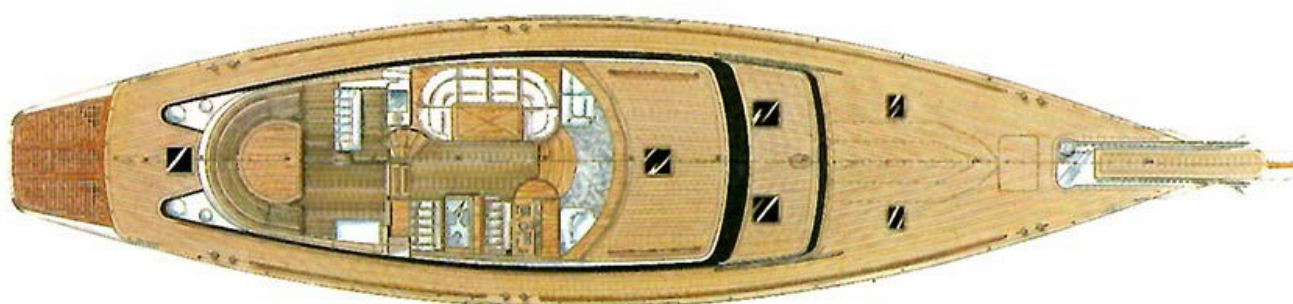
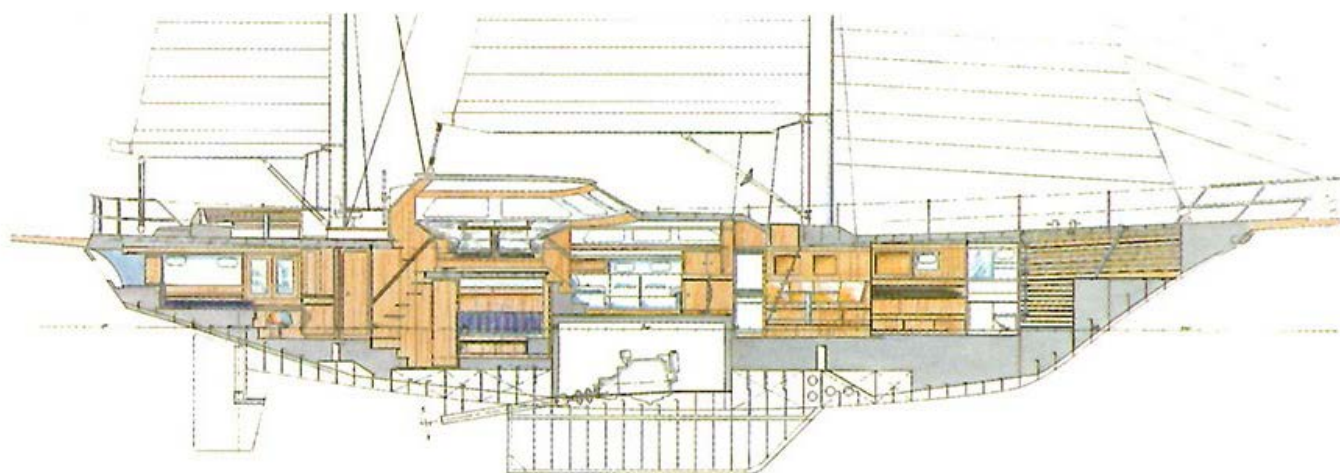

Hull

Construction

: The hull and superstructure of the yacht are made out of steel and the wheelhouse of teakwood.

Steel : Fe 420, grade A, with material certificate 3.1.C.

Keel

: The yacht is executed with a "Jongert Design" keel with a draught of 3,20 m.

Portlights

: 20 stainless steel portlights are welded into the hull. The window frames are made out of stainless steel and the windows will be made of safety glass.

Platform

: A platform has been installed on the aft ship. This platform consists of a metal frame and a teak wooden grating. A gangway and a bathing ladder are integrated in the teak wooden grating of the platform.

JONGERT®

Paint system

- Grit blasting : The yacht has been grit blasted.
Quality: SIS-SA 2-2½.
- Paint system : After grit blasting a complete International paint system has been applied.
- Colour of topcoat : The colour of the topcoat is Flag Blue with white stripe for portholes.

Isolation

- Thermal isolation : For thermal isolation of the hull (with exception of the engine room and fore peak) Polyurethane (PUR) foam isolation has been applied. All surfaces adjoining the open air, including the frames up to 100mm under floor level are isolated with approximately 30mm Polyurethane foam.
- Sound isolation : The engine room has been covered, on the inside, with mineral wool and foreseen with "Firet" cloth. The whole has been finished with a layer of white sprayed perfo-rated aluminium plate. The engine room door is covered with a perforated aluminium plate. The outside of the engine room bulkheads, ventilation ducts as well as the engine room ceiling are covered with "Phone-killer" sprayable isolation compound.
- Interior isolation : The partition walls of the owner's cabin have been isolated by means of "multi sandwich" bulkheads with integrated lead layer in order to reduce transmission of noise from the guest cabins.

Superstructure and Deck

- Windows superstructure : 6 flat windows of hardened, clear glass, thickness 8mm.
- Windows wheelhouse : 9 flat windows of hardened, clear glass, thickness 12mm as front and side windows. 1 flat window in the back wall and 1 flat window for the wheelhouse door, made of hardened glass, thickness 8mm.
- Windscreen wipers : 2 windscreen wipers, separately controlled, with interval switch.
- Bollards : 6 stainless steel double bollards.
- Fairleads : 6 stainless steel fairleads with nylon rollers.
- Sea railing : A complete stainless steel sea railing with stanchions, pulpit and stern railing.
- Anchor winch : 1x Lewmar, type 4000, hydraulic vertical anchor winch with capstan, gypsy and stopper for 16 mm anchor chain.
- Anchor : 1x 180 lbs CQR anchor and 1x 140 lbs CQR anchor.
- Anchor chain : 1x 80m, 16mm, galvanized, quality U2.
- Anchor rope : 1x 80m, 26mm, polyester/ polypropylene.

JONGERT®

Deck hatches : Jongert standard flush deck hatch on the fore deck.
: Lewmar hand controlled hatches in:
- Saloon : 1x 620 x 620mm.
- Galley : 1x 620 x 620mm.
- Dinette : 1x 620 x 620mm.
- Captain's cabin : 1x 500 x 370mm.
- Crew cabin : 1x 500 x 370mm.
- Owner's cabin : 1x 620 x 620mm.

The hatch in the dinette can also be used as an entrance or exit hatch for the crew. Therefore a fixed ladder has been installed in the interior and two stainless steel hand rails on deck.

Deck equipment : The "Lewmar" deck equipment consists of the following:
- Main sheet system with control line system.
- Genoa sheet system.
- Stay sail sheet system.
- Mizzen sheet system.
- Reef system.
- Halyard blocks around the masts.

Winches : - 2x 88 SEST Electrical genoa sheet winches.
- 2x 66 SST Stay sail sheet winches.
- 1x 66 SST Main sail sheet winch.
- 1x 44 SST Main sheet control line winch.
- 2x 62 SST Reef winches.
- 1x 77 SST Main sail halyard winch.
- 1x 44 SST Mizzen halyard winch.
- 1x 44 SST Mizzen sheet winch.
- 1x 44 SST Mizzen reef winch.

- 2x 10" winch handle "lock-in".
- 2x 10" winch handle "double grip".

Masts and booms : "Nirvana Spars" main mast and boom, and mizzen mast and boom, provided with mast rail and "Harken" traveller. Measurements according to the sail plan.

Mastfoot and boomvang : Both masts are installed on deck by means of an aluminium mastfoot. The main mast is executed with a "Hydromar" hydraulic boomvang, type HBC-8. The mizzen boom is executed with a "Lewmar" tackle.

Standing rigging : Standing rigging is executed in stainless steel wire and rod rigging for forestay and inner forestay.

Sheets : Cupsheet and Gemini according to the deck plan.

Halyards : Cupsheet and Gemini according to the deck plan.

Halyard tensioners : 2x "Hydromar" hydraulic halyard tensioners, suitable for genoa and stay sail.

JONGERT®

Backstay tensioner : 1x "Hydromar" hydraulic tensioner, type HSC-8-5, operated by means of a hand pump panel.

Fore stays : 1x Reckmann hydraulic furl, type RF 90-4 with RS profile for forestay and 1x Reckman manual operated furl, type 2000/40 for inner forestay.

Sails : The yacht has been provided with the following sails:

- Main sail : 95,00 m²
- Mizzen sail : 32,00 m²
- Genoa : 156,00 m²
- Staysail : 61,00 m²

Engine room

Main engine : 1x MTU 10V-183-AA-91, 345hp/ 254kW at 2.300 rpm with "ZF" reverse gear, flexible coupling, chromed valve covers and injection lines.

The main engine is executed with the following:

- Internal cooling system, executed with seawater cooled heat exchanger.
- Alternator for start batteries.
- Alarms and indicators.
- "Steimel" outboard cooling water pump.
- Hydro pump to drive the bow thruster.

Exhaust system main engine : Wet exhaust system exiting in the side of the hull.

Fuel system : A fuel system with a double switchable "Man" filter system and a tank capacity of approx. 4.200 litres.

Control system main engine : A "Mathers" electronic 24V one-handle control, type Micro Commander MMC 585 installed on the outside and inside steering position.

Propeller shaft : The "Rubber Design" propeller shaft installation consists of a closed system with self-centring radial and axial thrust bearing in oil bath and a Hundersted variable pitch propeller, diameter of 810mm. To charge the service batteries, one 120A alternator has been installed on the propeller shaft installation.

Bow thruster : A fixed "Hydromar" tunnel type, 45hp/ 33kW. The bow thruster is hydraulically driven by means of a hydraulic pump connected to the main engine.

Generator : - 1x "ONAN" MC-CBA, 30kW.

Airco outlets with fancoil units are installed in the following cabins:

- 1x Owner's cabin : 24.000 BTU.
- 2x Guest cabin : 9.000 BTU.
- 2x Crew cabin : 9.000 BTU.
- 1x Dinette : 17.000 BTU
- 2x Wheelhouse : 17.000 BTU.
- 2x Saloon : 17.000 BTU.

In every cabin, 1 digital thermostat control unit can control the temperature.

The Boiler system can be used in order to heat the cabins.

- Fire prevention : -1x 5 kg CO₂ fire extinguisher in the engine room.
-7x 2 kg powder fire extinguishers throughout the yacht.

Electrical installation

- 230-400V-AC main switchboard : The 230-400V-AC main switchboard has been installed in the engine room.
- Main engine and generator start panel : The main engine and generator start panel will be installed in the engine room.
- 24V-DC main switchboard : The 24V-DC main switchboard has been installed in the engine room.
- Batteries : - 1 set 24V "Sonneschein" maintenance free service batteries, capacity 1.200Ah.
- 1 set 24V "Sonneschein" maintenance free start batteries, capacity 400Ah.
Service bateries renewed in 2017.
- Battery chargers : 2x 75A "Mastervolt", 3x400V-AC.
1x 12A "Mastervolt", 24V-DC.
- Shore power connection : 3x400V-50Hz-32A Shore power connection, including shore isolation transformer.
- Navigation lights : - Position lights SB and PS integrated in the sea railing.
- Steam light in the mast.
- Stern light at the platform.
- Red over green light in the mast.
- Anchor light (supplied separately).
- Interior lights : According to the "Jongert" standard and the lighting plan.

JONGERT®

Inverter : The "Mastervolt" 24V-DC-230V-50Hz inverter, with a capacity of 1.500 VA-trapezium, feeds the 230V wall sockets if generator/ shore power connection are not operational.

Central alarm and control panel : The central alarm and control panel is installed in the wheelhouse for the following functions:

Alarms:

- Grey water tanks "Full" alarm.
- Black water tanks "Full" alarm.
- Bilge system alarm.
- Fire alarm in engine room.
- Hydraulic oil "Low" level.
- Hydraulic oil "High" temperature alarm.
- Oil pressure "Low" alarm main engine.
- Temperature "High" alarm main engine.
- Exhaust "High" temperature alarm.
- Capacity "Overload" alarm generator sets.

Controls:

- Sail functions powerpack.
- Shore functions powerpack.
- Bilge system.
- Electrical cut-off valves bilge system.
- Wastewater system.
- Ventilation interior.
- Ventilation engine room with "Emergency" stop.
- Air conditioning system.
- Generator systems.
- Navigation lights.
- Deck lights in spreaders.

Galley appliances

Refrigerator : - 2x "Frigonautica", total capacity 390 litres, in galley.
- 1x "Frigonautica", at outside steering position.

Freezer : - 2x "Frigonautica", total capacity 390 litres, in galley. Ice maker in the bar.

Washing machine : - 1x "Miele", W 936-WPS.

Wash dryer : - 1x "Miele", T-699-C.

Dishwasher : - 1x "Miele", G-6990-SLI.

Ceramic cooking plate : - 1x "Miele", KN 125.

Cooker hood : - 1x "Miele", H-236-E.

Hot air oven : - 1x "Miele", H-236-E.

Micro wave oven : - 1x "Miele", M-626-EG.

JONGERT®

Audio/ Video equipment : The yacht has been equipped with a Bose sound system in the salon. Add. audio/ video equipment installed throughout the yacht.

- Television : - 1x "flatscreen" in owner's cabin.
- 1x "flatscreen" in Saloon.
- 1x "flatscreen"
- Video recorder/ player : - 1x "Philips" in owner's cabin.
- 1x "Philips" in Saloon.
- Radio/ CD player : - 1x "Panasonic" in owner's cabin.
- 1x "Panasonic" with CD-changer in saloon.
- Speakers : - 2x "Pioneer" in owner's cabin.
- 2x "Pioneer" in saloon.
- 2x "Pioneer" in wheelhouse.
Speakers in saloon and wheelhouse are connected with radio/ CD player in saloon.

Communication equipment

- VHF : "SP-Radio" Sailor RT 4822 installed on the inside steering position, inclusive a "SP-Radio" DSC receiver modem.
- Satcom : "ABB-Nera" Inmarsat M installed on the inside steering position, inclusive a connection with the central telephone/ intercom system.
- Central telephone/ intercom : "Siemens" Hycom 120 central telephone/ intercom system installed with 8 single telephones throughout the yacht.
- SSB : "Sailor" RE-2100-Simplex has been installed.
- GSM telephone : "Motorola" Phonocell installed with connection to the central telephone/ intercom system.
- Fax : "Toshiba" TF-P-100 installed in the wheelhouse with shore, Satcom and GSM connection.

Navigation equipment

- Radar : "Furuno" FR-1941-DA-4 installed with screen on the inside steering position and connection to the Sailing computer. Furuno 1751.
- Magnetic compass : "Sestrel" Major 350-120 installed on the outside steering position and a "B&G" compass as back-up for autopilot system.
- Sailing computer : "B&G" Hydra 330 installed on the outside and inside steering position and with connections to

JONGERT®

the radar, GPS and autopilot system with the following indications:

- Compass.
- Rudder position.
- Wind speed.
- Boat speed.
- Wind direction.
- Magnified wind.
- Depth.
- Halcyon compass.

- GPS Navigator : "Philips" APN-MK-6 installed in the wheelhouse with a man overboard module on the outside steering position and connections to the radar and sailing computer system. AIS.
- Chart plotter : "Ratheon" chart plotter installed in the wheelhouse with connections for the GPS and B&G signal.
- Echo sounder : "Incastec" Echopilot FLS-2 has been installed.
- Barometer : "Prosser" Weather trend digital barometer installed in the wheelhouse.

Steering system

- Steering machine : "Hydromar" HF-210-FB hydraulic steering machine has been installed with a stainless steel steering wheel at the outside steering position and a tiller unit on the inside steering position.
- Autopilot system : B&G Hydrapilot-2 has been installed in the wheelhouse with connection to the sailing computer.

Exterior

- Teak deck : A teak deck has been installed, consisting of teak strokes of 48 x 15mm and by means of rubber compound fixed on 15mm plywood.
- Outside steering position : The outside steering position has been executed with a stainless steel steering wheel and settee with cushion and with controls and indication equipment.
- Bathing ladder : An aluminium bathing ladder has been supplied which can be installed on both sides of the yacht. A second stainless steel high polished bathing ladder has been provided which can be installed on the platform.

JONGERT®

Life rafts : Two "Autoflug" eight-persons life rafts.

Cockpit : Comfortable U-shaped teak wooden bench and a teak wooden cockpit table.

Interior

Interior lay-out : The interior wood work has meet the highest quality demands. Lay-out according to the general plan.

Kind of wood : The interior wood work has been made out of natural mahogany veneer according to the standard Jongert-styling.

Ceilings : Ceilings in the cabins will be covered with Muraldaim (a suède-look upholstery material). Ceilings in the galley, dinette and bath cabins are silk gloss painted.

Upholstery : The yacht has been executed with the following upholstery:

- Curtains.
- Sofa's and settees.
- Head and side boards of the beds.
- Mattresses.
- Carpeting.

Hinges and locks : "Jado" Duoline chrome or brass-plated.

Taps and accessoires : "Hans Grohe", type Mondial.

Toilets : 5x "Actana" Waterflash electrical toilets.

Shower cabins : 4x shower cabins in crew and guest bath cabins and 1 shower/ bath in the owner's bath cabin.

Wash basins and tops : Corian tops with integrated Corian wash basins.

Galley top : Corian with double integrated wash basin.

Cupboards : Each cabin has been provided with cupboards.

Lath bottoms of beds : All the beds has been provided with lath bottoms.

Ornaments : The yacht has been executed with a stern plate, a woman's head and a bow plate on both sides of the yacht.

Inventory

Warps	:	4 ea., polypropylene/polyester, length 25 m, diam. 22 mm.
Fenders	:	6 ea.
Life buoys	:	2 ea.
Boat hook	:	1 ea.
Pail with rope	:	1 ea.
Flagpole with fitting	:	1 ea.
Dipsticks	:	2 ea.
Anchor ball	:	1 ea. (black)
Spare materials	:	- 1 Set of spare varnish and paint. - 1 Can of lubricating oil for the diesel engines. - 1 Can of lubricating oil for reduction gear. - 1 Can of hydraulic oil for the steering gear. - 1 Can of lubricating oil for the propeller shaft.



JONGERT®



JONGERT®



JONGERT®





JONGERT®



JONGERT®

